

This record,

SP 562

was remediated to this Property
File, Valuation No./Prop.ID:

617-563-24

by the "I" on Paper Team on

10-10-02.



Janet Stephenson

8 May 1992

Davenport Solicitors
P. O. Box 1264
AUCKLAND

ATTN : MR GIBSON

Dear Sir

RE : MR WYNYARD/M.E. DRUM - LOTS 3 & 5 DP 121200
TAPP ROAD, KOUTU, HOKIANGA

Mr Drum has asked me to write to you with information on the subdivision standards in the Rural 1 zone.

I enclose a copy of these standards.

Basically, once the title for Lots 3 & 5 DP 121200 has been in existence for 5-years, the owners may apply for a new subdivision.

Our information is that a title for Lots 3, 4 & 5 was issued on 20 January 1988. A subsequent boundary adjustment removed Lot 4 from the title; however as no extra titles were created we are willing to accept that the 5-year period can date from 20 January 1988.

A further complying subdivision can therefore be applied for on or after 20 January 1993.

Yours faithfully

Janet Stephenson
RESOURCE PLANNER

ENCL.

JRS:lmb
JRS\PLN\NA\WYN-DRUM.DAV

FAR NORTH DISTRICT COUNCIL
Rawene Service Centre

PO Box 3
RAWENE

Parnell Street
RAWENE

Phone : (09)4057 829

Fax : (09)4057 898

FACSIMILE TRANSMISSION

TO : DOVENPORTS ATTN: MR GIBSON
FAX N° : 09-307 0259
FROM : JANET STEPHENSON
DATE : 14-5-92
TOTAL N° OF PAGES : 2
(Including Leader Page)

If you have not received all the pages or find that any of them are illegible, please call the sender)

MESSAGE :

RE: MIKE DRUM

PLANNING : (Continued)

M. E. Drum S.P.562
To Subdivide Pt Sec 3 of Block III Hokianga S.D.

Resolved

"THAT pursuant to Section 279 of the Local Government Act 1974 the Hokianga County Council consents to the subdivision of Pt Sec 3 of Block III Hokianga S.D. subject to :

1. A Reserve Contribution of \$1,500.00 being paid.
2. Lots 3, 4 & 5 being held in one title."

Herbert/Williams
Carried

Hokianga Quarries N.A.245
To Subdivide an Area of Land to Establish a Site as a Depot

Resolved

"THAT pursuant to Section 72 of the Town and Country Planning Act the Hokianga County Council consents to the application of Hokianga Quarries Ltd subject to :

1. Road access being provided from Wharekawa Road to the satisfaction of the County Engineer.
2. A Reserve Contribution of \$600.00 being paid.
3. That area shown as S, R & Q be held as one lot and further that it be recommended that the applicant proceed with the acquisition of the dis-used road shown as S on S.D. Plan 54242."

Williams/Reid
Carried

Hokianga County Council S.P.471

Resolved

"THAT Council initiate reserve status for Lot 3 AND FURTHER THAT a sum of money from Council's Reserves Account be made available to purchase appropriate native plants for planting of Lot 3 AND FURTHER THAT a P.E.P. project be investigated with the understanding that planting will be done this autumn."

Herbert/Reid
Carried

LUCAS
WAKANGA

WAKANGA

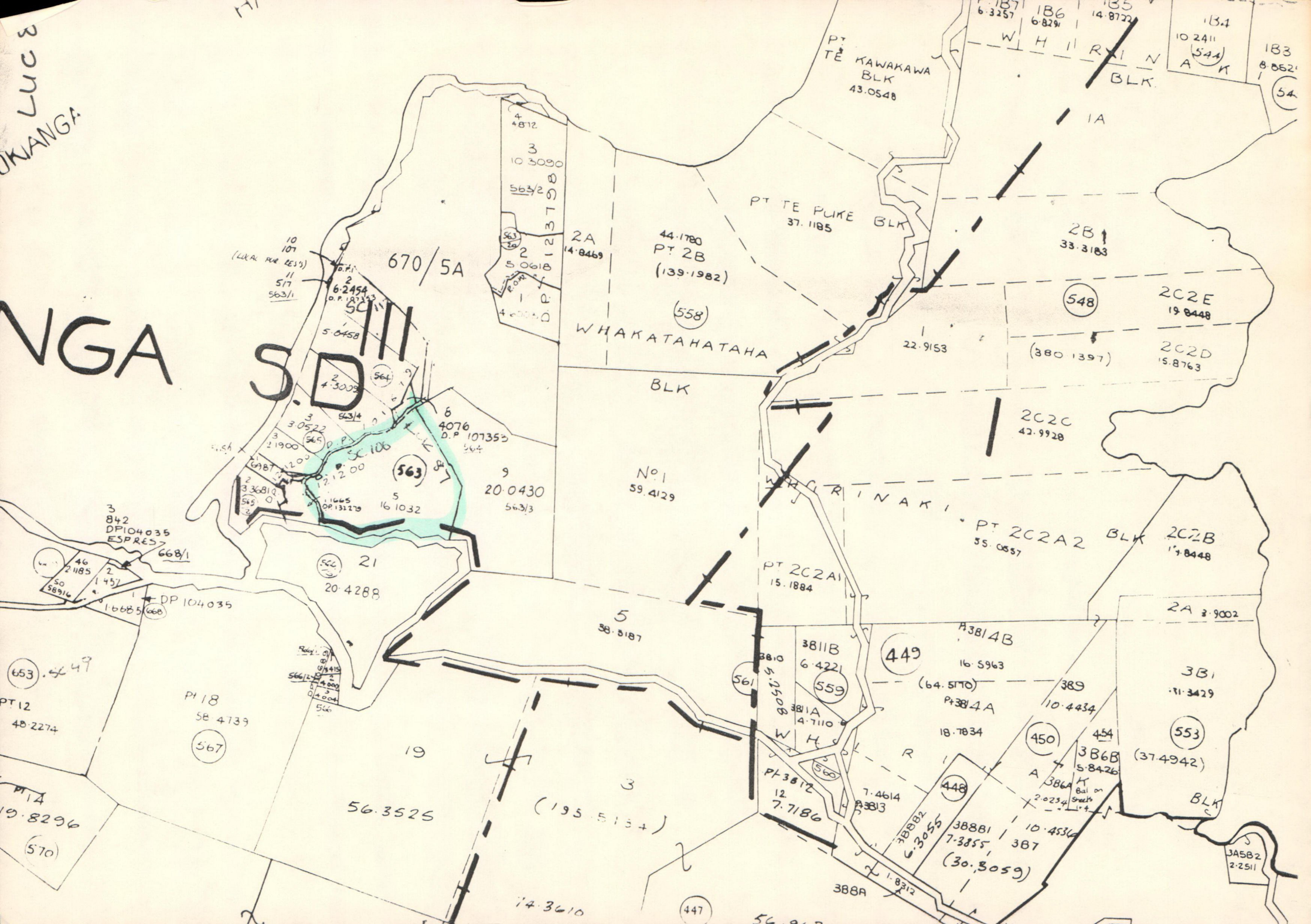

10 107
11 517
563/1
(LOCAL RES)

670/5A

2A
14.8469

44.1780
PT 2B
(139.1982)

PT TE PUKE BLK
37.1185

2B
33.3183

SD III

WHAKATAHATAHA
BLK

2C2E
19.8448

2C2D
15.8763

Nº1
59.4129

WHAKATAHATAHA
BLK

2C2C
42.9928

3 842
DP104035
ESPRES

21
20.4288

PT 2C2A2 BLK
55.0557

2C2B
17.8448

PT 2C2A1
15.1884

5
58.5187

2A 2.9002

(653) 449

PT 12
48.2274

PT 18
58.4739

(567)

3814B
16.5963

3B1
11.3429

(449)

3814A
(64.5170)

389
10.4434

(450)

454
386B
5.8426

(553) (37.4942)

56.3525

(195.5134)

(448)

3881
7.3855

(30.3059)

387
10.4536

PT 14
19.8296

(570)

14.3610

(447)

3A5B2
2.2511

HARBOUR

HOKIANGA

HOKIANGA

"DIAG 'B'
TE WAIPUNA

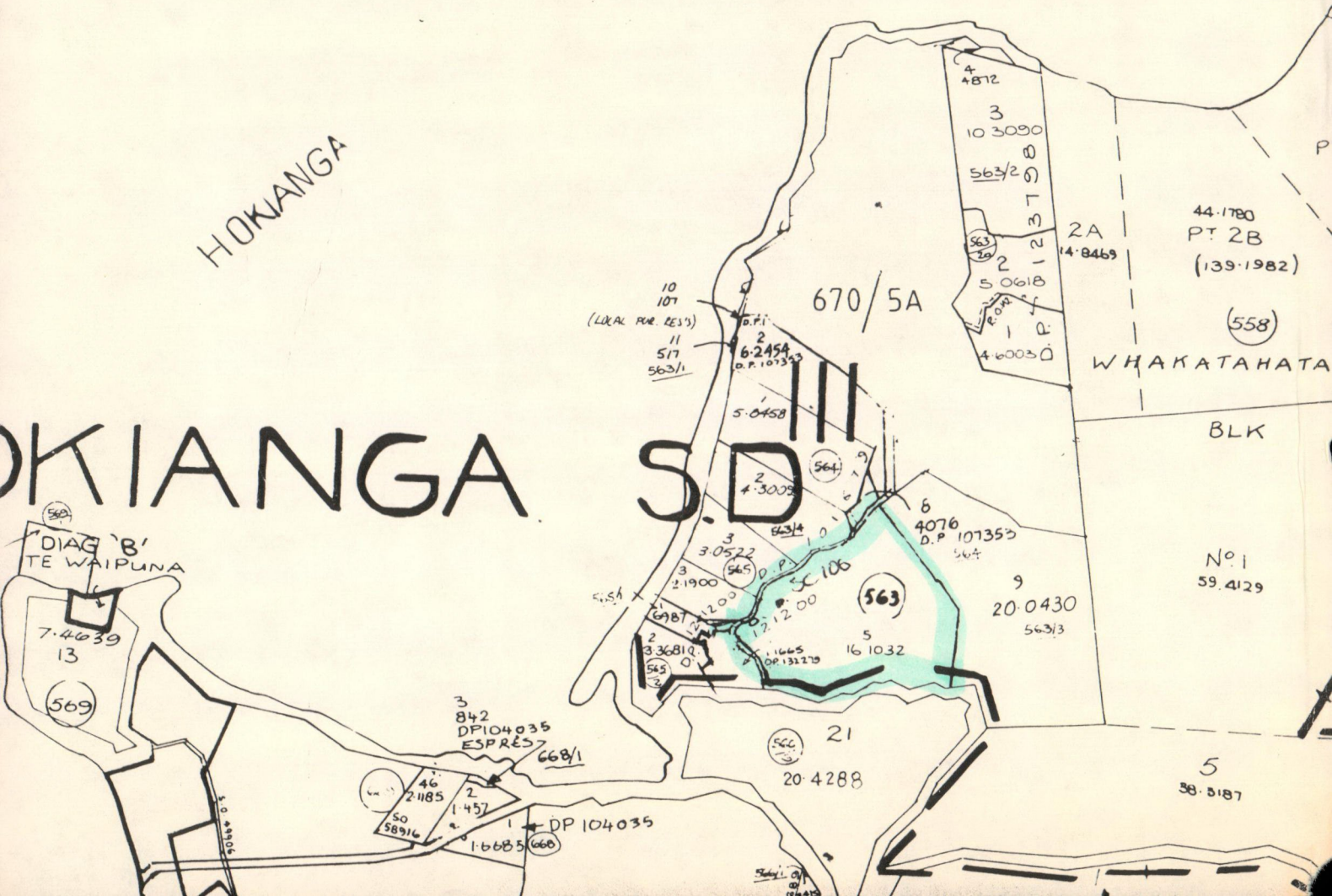

44-1780
PT 2B
(139-1982)

(558)

WHAKATAHATA

BLK

No 1
59.4129

9
20 0430
563/3

6
4076
D.P. 107353
564

3
30522
565

3
21900
565

2
33681
565

3
842
DP104035
ESPRES

46
21185

50
58916

2
1.457

1
1.6685

DP 104035

21
20-4288

5
38-5187

670/5A

2A
14-8469

4
4872
3
10 3090
563/2
50618
460030

10
107
(LOCAL PUB. RES.)

11
517
563/1

6.2454
D.P. 107343

5.0458

2
4.3008

3
3.0522
565

2
2.1900
565

2
3.3681
565

1
1.665
D.P. 132279

563

5
161032

560
21

20-4288

560
5

560