

INSPECTIONS



005

SITE INSPECTION SHEET
Sleepout and Home Office

Date booked	Officer	Signed
20/1/14	MGS	MALCOLM

Applicant Name:	Brendan Nichols	Consent N ^o :	BC-2014-699/0
Project Location:	PID 3328410, 7849 State Highway 12, Waimamaku 0473	Date:	16-Jan-2014
Contact Person:	Hans Mitt	Contact Phone:	09-4054 876

Ground Roughness	T1		T2		T3		T4	
	Sheltered	Exposed	Sheltered	Exposed	Sheltered	Exposed	Sheltered	Exposed
Urban	L	M	M	H	H	H	H	VH
Open	M	H	H	VH	H	VH	VH	EH

***Site Topography:**

- Gentle Moderate Steep

***Exposure Zones:** NZS3604

- B = Low C = Medium D = High (Sea Spray)

***Microclimatic considerations:** NZS3604

- A = Industrial /corrosive atmospheres YES / NO
 B = Agricultural chemicals / fertilisers YES / NO
 C = Geothermal hot spots YES / NO

***Vehicle Crossing:**

- New Crossing required YES / NO
 Existing Crossing YES / NO
 Is it dangerous or unsafe YES / NO
 Does it comply with FNDC standards YES / NO

***Rapid Number:** is one required: YES / NO

***Existing Structures on Site:** YES / NO

Nos. _____
 Type. Dwelling & Sheds

***Excavation – RC Checks** Yes / NO

Volume (work not started)

- Less than 200m3
 Exceeds 200m3
 Exceeds 300m3
 Exceeds 5000m3

Cut / Fill Height

- Less than 1.5m
 Exceeds 1.5m

***Excavation – EWP Checks** YES / NO

- Fill exceeds 50m3
 Within 3m of boundary
 Greater than 500mm in Depth

***Waterways:**

- Any waterways present YES / NO
 Average Width of Waterway: _____ metres
 Distance from proposed project: _____ metres

***Hail:** - Land likely subject to: YES / NO

***Flood Zone:** is site prone to flooding? YES / NO

***Hazards:** Is Sec 72 required YES / NO

- Erosion Falling Debris Subsidence
 Inundation Slippage

***Building across boundary:** YES / NO

Sec 75 required

***Is a Geotech Report Req:** YES / NO

***Engineering Required:** YES / NO

- Signs of slippage
 Poor soils
 Fill on site
 Un-natural profiles
 Flooding
 Foundations

***Council Services available:** YES / NO

- Sewer Water Stormwater

***Easements:** YES / NO

- Man hole covers Overland flow path
 Stormwater disposal Overhead wires / kerb outlet

***On-site Effluent Disposal:**

- Is the area suitable
 Is there room for a reserve area
 If there local knowledge of poor soakage
 Engineering Design required
 Ground Water Protection required

***Estimated Soil Category:**

- Gravel, sand- rapid drainage
 Sandy loams- well drained
 Loams- moderately drained
 Clay Loams- imperfectly drained
 Light clays- poorly drained
 Medium to heavy clays- very poorly drained

Taken:

- Site photos Footpath damage (if applicable)

Comments: (PTO for Sketch or further comments)

No Earth works site to be left as is.

Maps attached / applicable to this site: <input checked="" type="checkbox"/> SITE PLAN	<input checked="" type="checkbox"/> LOCATION zoom In-zone	<input checked="" type="checkbox"/> LOCATION zoom out	<input checked="" type="checkbox"/> AERIAL	<input checked="" type="checkbox"/> HAZARDS	<input checked="" type="checkbox"/> SERVICES	<input checked="" type="checkbox"/> HPT
--	---	---	--	---	--	---

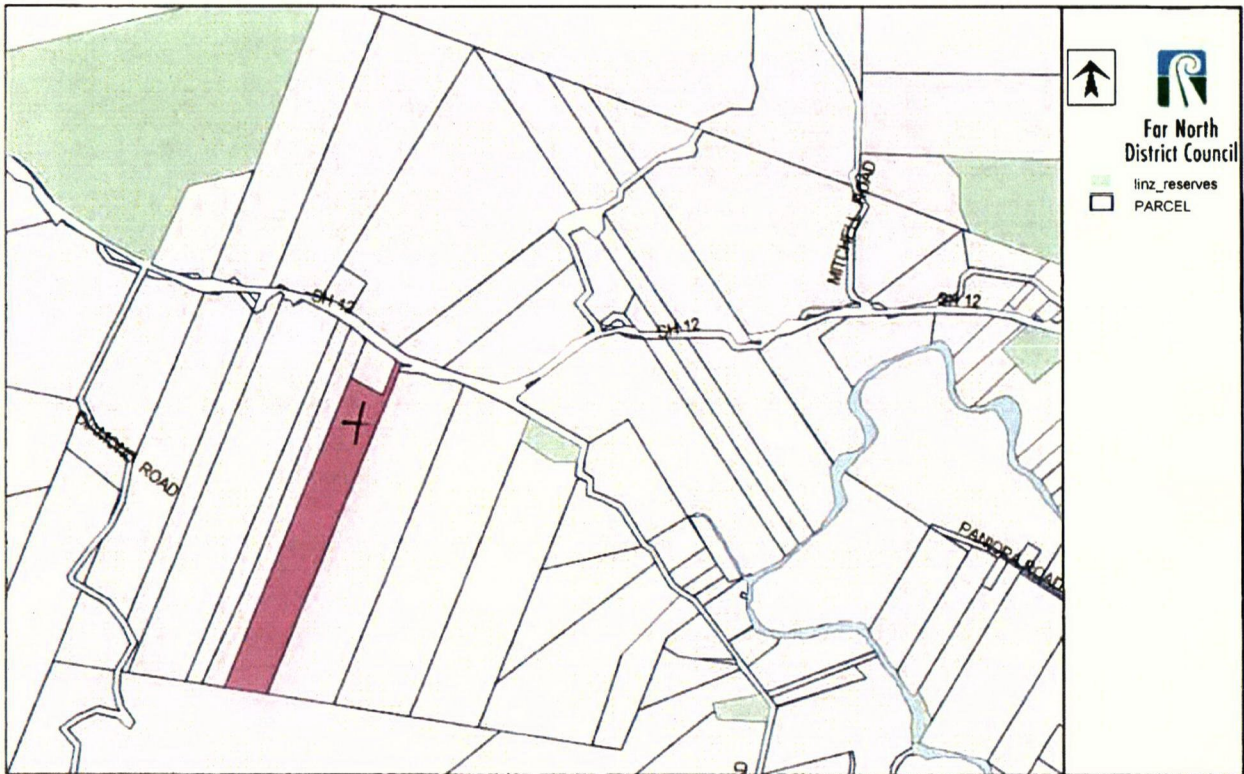

This map has been provided in good faith and for information purposes only. The Far North District Council is not liable for any errors or omissions. Any persons considering purchasing property are advised to have all boundaries confirmed by a licensed Cadastral Surveyor.

Produced by the Far North District Council 12:45
16/01/2014

Copyright © 2006 Far North District Council

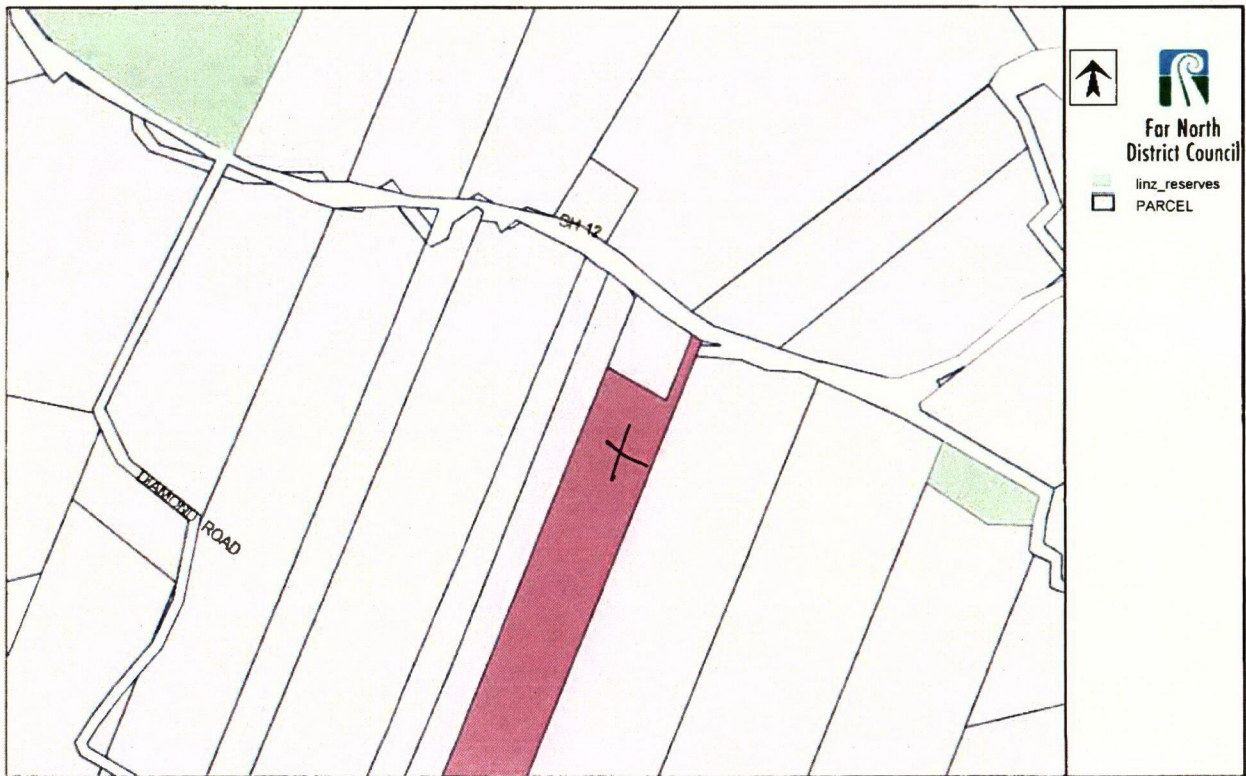

This map has been provided in good faith and for information purposes only. The Far North District Council is not liable for any errors or omissions. Any persons considering purchasing property are advised to have all boundaries confirmed by a licensed Cadastral Surveyor.

Produced by the Far North District Council 12:44
16/01/2014

Copyright © 2006 Far North District Council



This map has been provided in good faith and for information purposes only. The Far North District Council is not liable for any errors or omissions. Any persons considering purchasing property are advised to have all boundaries confirmed by a licensed Cadastral Surveyor.

Produced by the Far North District Council 12:45 16/01/2014

Copyright © 2006 Far North District Council



Far North District Council

- PARCEL_Line
- Aerial Low 2002
- Satellite 2008
- Aerial High 2006
- AerialHigh 2000-2003

This map has been provided in good faith and for information purposes only. The Far North District Council is not liable for any errors or omissions. Any persons considering purchasing property are advised to have all boundaries confirmed by a licensed Cadastral Surveyor

Produced by the Far North District Council 12 46
16/01/2014

Copyright © 2006 Far North District Council

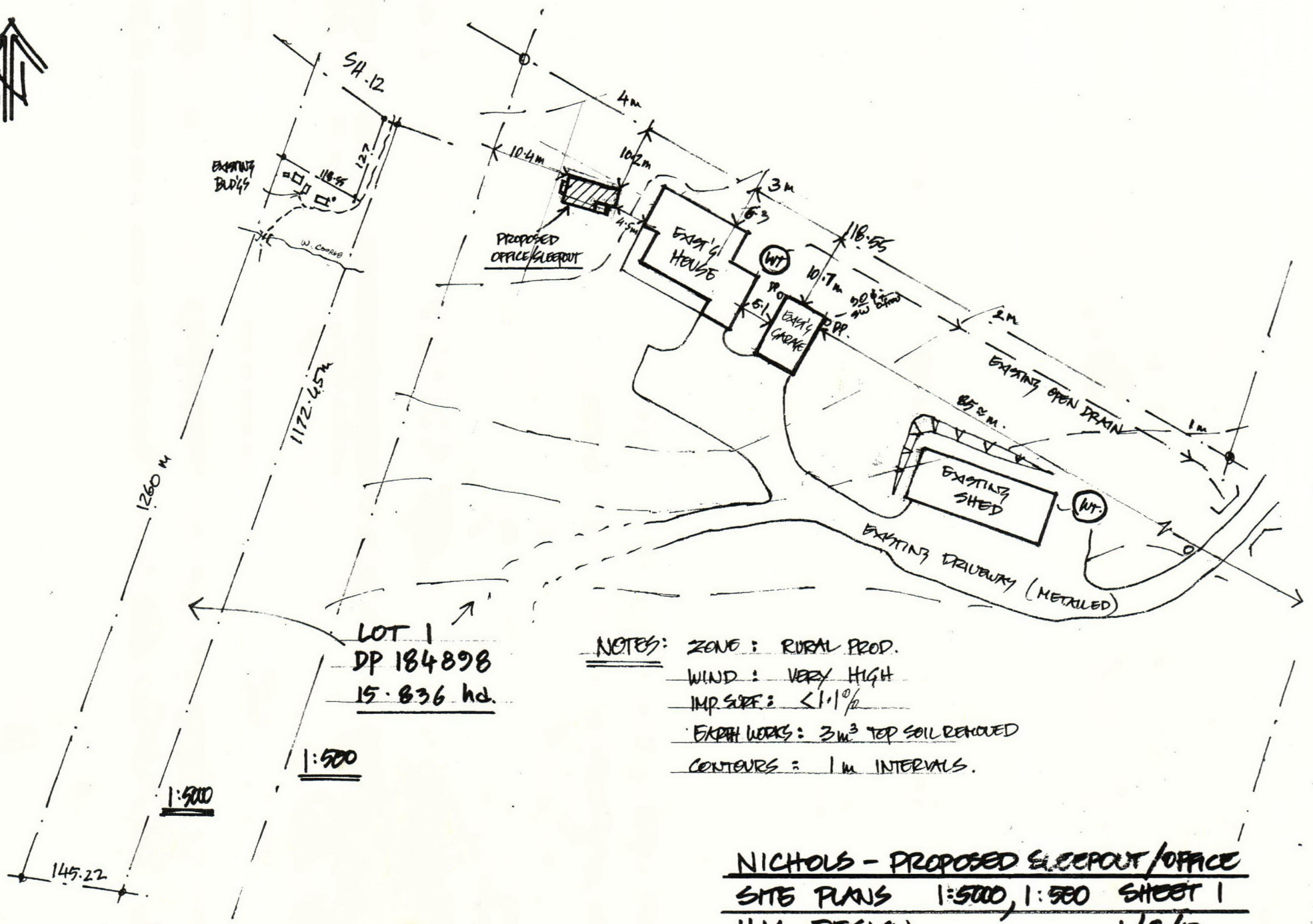

LOT 1
DP 184898
15.836 ha.

- NOTES:
- ZONE: RURAL PROD.
 - WIND: VERY HIGH
 - IMP SURF: <math>< 1.1\%</math>
 - EARTH WORKS: 3m³ TOP SOIL REMOVED
 - CONTOURS: 1m INTERVALS.

NICHOLS - PROPOSED SLEEPOUT/OFFICE
SITE PLANS 1:5000, 1:500 SHEET 1
H M DESIGN 1/8/12





20/JAN/2014



20/JAN/2014





20/JAN/2014

SITE INSPECTION SHEET

•Sleepout and Home Office

Date booked	Officer	Signed

Applicant Name:	Brendan Nichols	Consent N ^o :	BC-2014-699/0
Project Location:	PID 3328410, 7849 State Highway 12, Waimamaku 0473	Date:	16-Jan-2014
Contact Person:	Hans Mitt	Contact Phone:	09-4054 876

Ground Roughness	T1		T2		T3		T4	
	Sheltered	Exposed	Sheltered	Exposed	Sheltered	Exposed	Sheltered	Exposed
Urban	L	M	M	H	H	H	H	VH
Open	M	H	H	VH	H	VH	VH	EH

***Site Topography:**

Gentle Moderate Steep

***Exposure Zones:** NZS3604

B = Low C = Medium D = High (Sea Spray)

***Microclimatic considerations:** NZS3604

A = Industrial /corrosive atmospheres **YES / NO**

B = Agricultural chemicals / fertilisers **YES / NO**

C = Geothermal hot spots **YES / NO**

***Vehicle Crossing:**

New Crossing required **YES / NO**

Existing Crossing **YES / NO**

Is it dangerous or unsafe **YES / NO**

Does it comply with FNDC standards **YES / NO**

***Rapid Number:** is one required: **YES / NO**

***Existing Structures on Site:** **YES / NO**

Nos. _____

Type. _____

***Excavation – RC Checks** **Yes / NO**

Volume (work not started)

Less than 200m3

Exceeds 200m3

Exceeds 300m3

Exceeds 5000m3

Cut / Fill Height

Less than 1.5m

Exceeds 1.5m

***Excavation – EWP Checks** **YES / NO**

Fill exceeds 50m3

Within 3m of boundary

Greater than 500mm in Depth

***Waterways:**

Any waterways present **YES / NO**

Average Width of Waterway:- _____metres

Distance from proposed project: _____metres

***Hail:** - Land likely subject to: **YES / NO**

***Flood Zone:** is site prone to flooding? **YES/ NO**

***Hazards:** Is Sec 72 required **YES / NO**

Erosion Falling Debris Subsidence

Inundation Slippage

***Building across boundary:** **YES / NO**

Sec 75 required

***Is a Geotech Report Req:** **YES / NO**

***Engineering Required:** **YES / NO**

Signs of slippage

Poor soils

Fill on site

Un-natural profiles

Flooding

Foundations

***Council Services available:** **YES / NO**

Sewer Water Stormwater

***Easements:** **YES / NO**

Man hole covers Overland flow path

Stormwater disposal Overhead wires

/ kerb outlet

***On-site Effluent Disposal:**

Is the area suitable

Is there room for a reserve area

If there local knowledge of poor soakage

Engineering Design required

Ground Water Protection required

***Estimated Soil Category:**

Gravel, sand- rapid drainage

Sandy loams- well drained

Loams- moderately drained

Clay Loams- imperfectly drained

Light clays- poorly drained

Medium to heavy clays- very poorly drained

Taken:

Site photos Footpath damage (if applicable)

Comments: (PTO for Sketch or further comments)

Maps attached / applicable to this site: <input checked="" type="checkbox"/> SITE PLAN	<input checked="" type="checkbox"/> LOCATION zoom In-zone	<input checked="" type="checkbox"/> LOCATION zoom out	<input checked="" type="checkbox"/> AERIAL	<input checked="" type="checkbox"/> HAZARDS	<input checked="" type="checkbox"/> SERVICES	<input checked="" type="checkbox"/> HPT
--	---	---	--	---	--	---