



**RECORD OF TITLE
UNDER LAND TRANSFER ACT 2017
CROSS LEASE**

Search Copy



R. W. Muir
Registrar-General
of Land

Identifier **CB12F/218**
Land Registration District **Canterbury**
Date Issued 05 April 1973

Prior References
CB329/201

Estate Fee Simple - 1/4 share
Area 857 square metres more or less
Legal Description Lot 2 Deposited Plan 4792
Registered Owners
Elliot James Hendry

Estate	Leasehold	Instrument	L 905042
		Term	999 years from 1.3.1973
Legal Description	Flat 3 Deposited Plan 33023 and Garage 3 Deposited Plan 33023		
Registered Owners	Elliot James Hendry		

Interests

905040 Lease of Flat 1 and Garage 1 DP 33023 Term 999 years from 1.3.1973 Composite CT CB12F/216 issued - 5.4.1973
905041 Lease of Flat 2 and Garage 2 DP 33023 Term 999 years from 1.3.1973 Composite CT CB12F/217 issued - 5.4.1973
905042 Lease of Flat 3 and Garage 3 DP 33023 Term 999 years from 1.3.1973 Composite CT CB12F/218 issued - 5.4.1973
905043 Lease of Flat 4 and Garage 4 DP 33023 Term 999 years from 1.3.1973 Composite CT 12F/219 issued
12444043.2 Mortgage to NZGT Custodians (Bluestone) Limited - 3.5.2022 at 3:01 pm

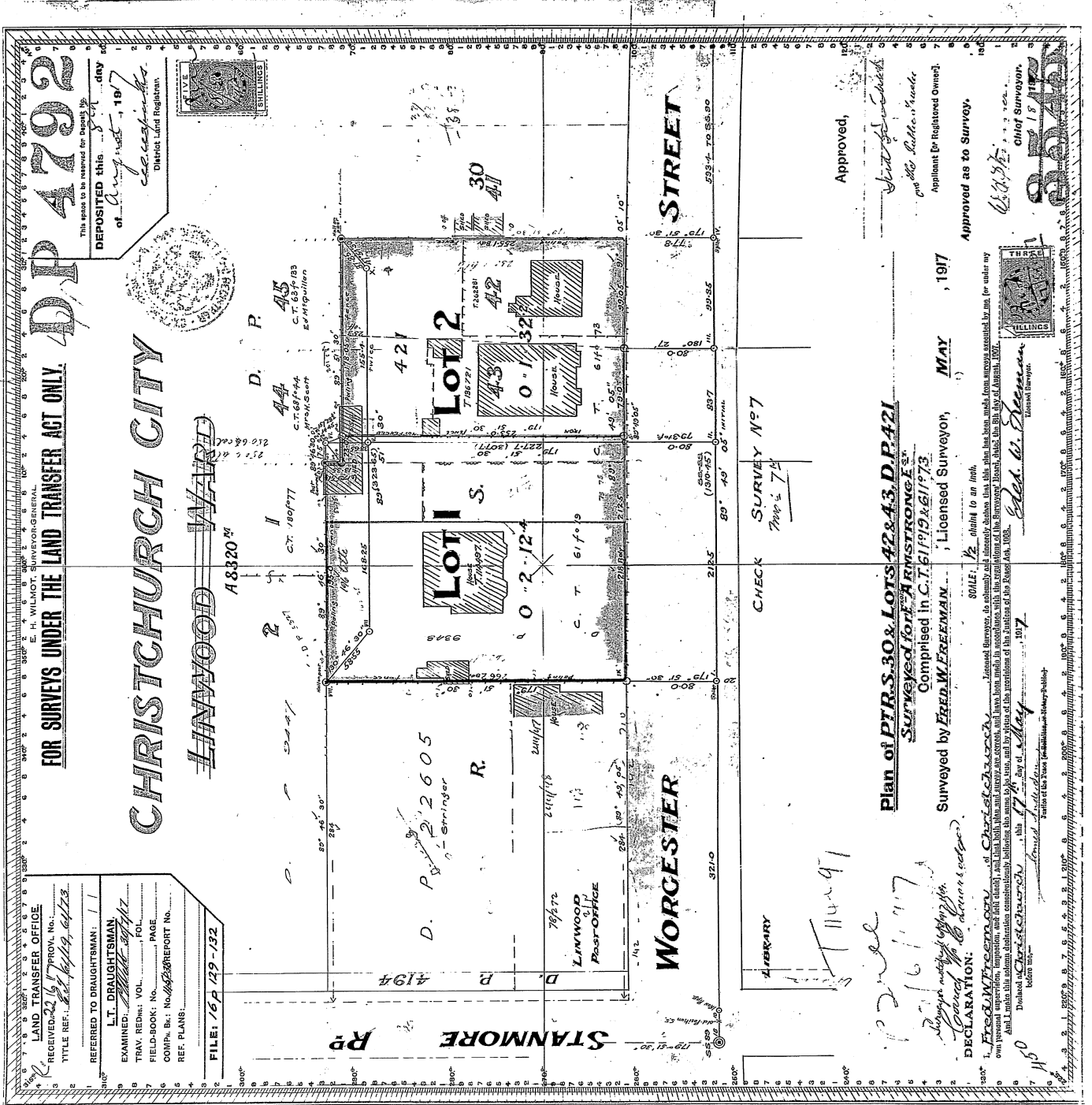

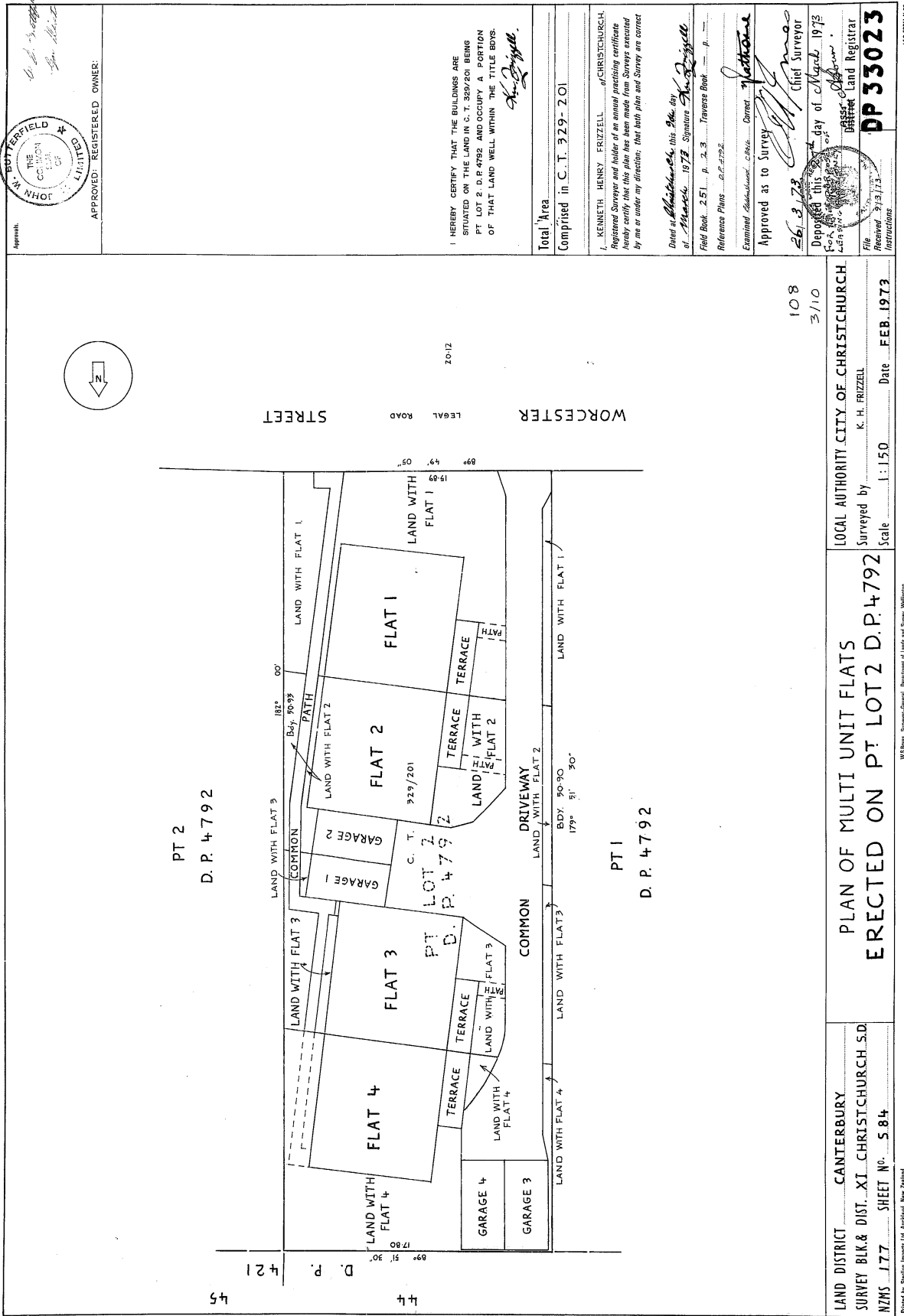

Approved: *[Signature]*
 APPROVED - REGISTERED OWNER:
 JOHN W. POTTERFIELD * C.E.D.
 THE COMMONS
 11, 12, 13, 14, 15, 16, 17, 18, 19, 20, 21, 22, 23, 24, 25, 26, 27, 28, 29, 30, 31, 32, 33, 34, 35, 36, 37, 38, 39, 40, 41, 42, 43, 44, 45, 46, 47, 48, 49, 50, 51, 52, 53, 54, 55, 56, 57, 58, 59, 60, 61, 62, 63, 64, 65, 66, 67, 68, 69, 70, 71, 72, 73, 74, 75, 76, 77, 78, 79, 80, 81, 82, 83, 84, 85, 86, 87, 88, 89, 90, 91, 92, 93, 94, 95, 96, 97, 98, 99, 100

I HEREBY CERTIFY THAT THE BUILDINGS ARE SITUATED ON THE LAND IN C. T. 329/201 BEING PT. LOT 2, D. P. 4792 AND OCCUPY A PORTION OF THAT LAND WELL WITHIN THE TITLE BOYS.
[Signature]

Total Area
 Comprised in C. T. 329-201

KENNETH HENRY FRIZZELL
 Registered Surveyor and holder of an annual practising certificate
 hereby certify that this plan has been made from surveys executed by me or under my direction; that both plan and survey are correct

Dated at *[Location]* this *[Day]* day of *[Month]* 1973
 Signature *[Signature]*
 Field Book 251 p. 2, 3 Traverse Book p. 1

Reference Plans *[List]*
 Examined *[Signature]* Correct
 Approved as to Survey *[Signature]*
 Chief Surveyor

Deposited this *[Day]* day of *[Month]* 1973
 District Land Registrar
 File *[Number]*
 Received *[Date]*

DP 33023
 Instructions

108
 3/10
 LOCAL AUTHORITY CITY OF CHRISTCHURCH
 Surveyed by K. H. FRIZZELL
 Date FEB. 1973
 Scale 1:150

PLAN OF MULTI UNIT FLATS
 ERECTED ON PT LOT 2 D.P. 4792

LAND DISTRICT CANTERBURY
 SURVEY BLK. & DIST. XI CHRISTCHURCH S.D.
 NZMS 177 SHEET NO. 584

Printed by Sterling Reports Ltd., Auckland, New Zealand.
 W.S. 8895. Survey-General, Department of Lands and Survey, Wellington.
 LIS FORM N 83