



**RECORD OF TITLE  
UNDER LAND TRANSFER ACT 2017  
FREEHOLD**

**Guaranteed Search Copy issued under Section 60 of the Land  
Transfer Act 2017**



  
R. W. Muir  
Registrar-General  
of Land

**Identifier** **65680**  
**Land Registration District** **Canterbury**  
**Date Issued** 22 January 2003

**Prior References**  
CB47A/196

---

**Estate** Fee Simple  
**Area** 700 square metres more or less  
**Legal Description** Lot 73 Deposited Plan 316821  
**Registered Owners**  
Tracey McLaughlin

---

**Interests**

5463694.7 Consent Notice pursuant to Section 221 Resource Management Act 1991 - 22.1.2003 at 9:00 am  
Land Covenant in Transfer 5463694.11 - 22.1.2003 at 9:00 am  
Fencing Covenant in Transfer 5522414.1 - 18.3.2003 at 9:00 am  
12514547.3 Mortgage to Southland Building Society - 17.8.2022 at 1:41 pm

hereby certify that this plan was prepared by the Office of the Registrar-General in accordance with the Resource Management Act 1991.

on the 14th day of November 2002

Subject to the granting or reserving of the easements and conditions set out hereon, the land shown on this amalgamation condition set out hereon.

Principal Administration Officer / Authorized Officer

There are no lots 1-66 & 107-609 on this plan.

**MEMORANDUM OF EASEMENTS**

Lot No.	Subplot	Dominant Tenement
67	B	lots 67-69
68	B	lots 67-69
69	B	lots 67-69
70	B	lots 67-69
71	B	lots 67-69
72	B	lots 67-69
73	B	lots 67-69
74	B	lots 67-69
75	B	lots 67-69
76	B	lots 67-69
77	B	lots 67-69
78	B	lots 67-69
79	B	lots 67-69
80	B	lots 67-69
81	B	lots 67-69
82	B	lots 67-69
83	B	lots 67-69
84	B	lots 67-69
85	B	lots 67-69
86	B	lots 67-69
87	B	lots 67-69
88	B	lots 67-69
89	B	lots 67-69
90	B	lots 67-69
91	B	lots 67-69
92	B	lots 67-69
93	B	lots 67-69
94	B	lots 67-69
95	B	lots 67-69
96	B	lots 67-69
97	B	lots 67-69
98	B	lots 67-69
99	B	lots 67-69
100	B	lots 67-69
101	B	lots 67-69
102	B	lots 67-69
103	B	lots 67-69
104	B	lots 67-69
105	B	lots 67-69
106	B	lots 67-69
107	B	lots 67-69
108	B	lots 67-69
109	B	lots 67-69
110	B	lots 67-69
111	B	lots 67-69
112	B	lots 67-69
113	B	lots 67-69
114	B	lots 67-69
115	B	lots 67-69
116	B	lots 67-69
117	B	lots 67-69
118	B	lots 67-69
119	B	lots 67-69
120	B	lots 67-69
121	B	lots 67-69
122	B	lots 67-69
123	B	lots 67-69
124	B	lots 67-69
125	B	lots 67-69
126	B	lots 67-69
127	B	lots 67-69
128	B	lots 67-69
129	B	lots 67-69
130	B	lots 67-69
131	B	lots 67-69
132	B	lots 67-69
133	B	lots 67-69
134	B	lots 67-69
135	B	lots 67-69
136	B	lots 67-69
137	B	lots 67-69
138	B	lots 67-69
139	B	lots 67-69
140	B	lots 67-69
141	B	lots 67-69
142	B	lots 67-69
143	B	lots 67-69
144	B	lots 67-69
145	B	lots 67-69
146	B	lots 67-69
147	B	lots 67-69
148	B	lots 67-69
149	B	lots 67-69
150	B	lots 67-69
151	B	lots 67-69
152	B	lots 67-69
153	B	lots 67-69
154	B	lots 67-69
155	B	lots 67-69
156	B	lots 67-69
157	B	lots 67-69
158	B	lots 67-69
159	B	lots 67-69
160	B	lots 67-69
161	B	lots 67-69
162	B	lots 67-69
163	B	lots 67-69
164	B	lots 67-69
165	B	lots 67-69
166	B	lots 67-69
167	B	lots 67-69
168	B	lots 67-69
169	B	lots 67-69
170	B	lots 67-69
171	B	lots 67-69
172	B	lots 67-69
173	B	lots 67-69
174	B	lots 67-69
175	B	lots 67-69
176	B	lots 67-69
177	B	lots 67-69
178	B	lots 67-69
179	B	lots 67-69
180	B	lots 67-69
181	B	lots 67-69
182	B	lots 67-69
183	B	lots 67-69
184	B	lots 67-69
185	B	lots 67-69
186	B	lots 67-69
187	B	lots 67-69
188	B	lots 67-69
189	B	lots 67-69
190	B	lots 67-69
191	B	lots 67-69
192	B	lots 67-69
193	B	lots 67-69
194	B	lots 67-69
195	B	lots 67-69
196	B	lots 67-69
197	B	lots 67-69
198	B	lots 67-69
199	B	lots 67-69
200	B	lots 67-69

**SCHEDULE OF AREAS**

Lot No.	Description	Area
67-106, 611, 614 & 615	Residential Lots	3,780sqh
611	Road to West in Christchurch	6633m <sup>2</sup>
614 & 615	Residential Lots	27m <sup>2</sup>
<b>Total Area</b>		<b>4,474.8ha</b>

Comprised in All C.T. 47A/196

*L. Christopher David Hawes of Christchurch*  
 being a person entitled to practice as a licensed cadastral surveyor,  
 (a) This survey to which this general notice is attached, and were undertaken by me or under my direction in accordance with the Cadastral Survey Act 2002 and the Survey-General's Rules for Cadastral Survey 2002;  
 (b) This notice is accurate, and has been created in accordance with that Act and those Rules.

(Signature) *L. Christopher David Hawes* (Date) 31/10/02

Field Book .....  
 Reference Plans .....  
 Examined .....  
 Approved as to Survey by Land Information NZ on 09/11/2003  
 Deposited by Land Information NZ on 22/11/2003

File No. DP316821  
 Received 29-11-02  
 DP316821

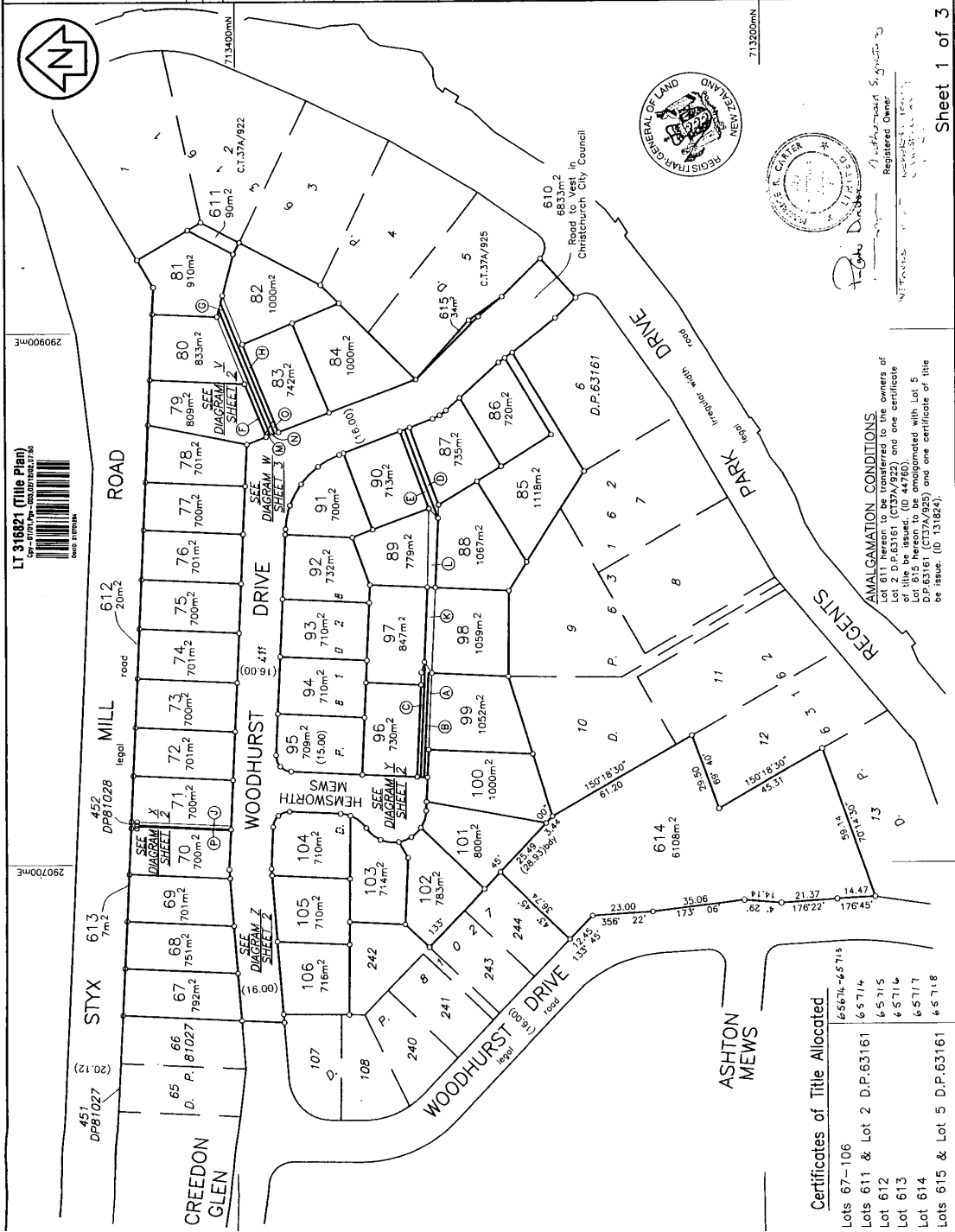

Sheet 1 of 3

TERRITORIAL AUTHORITY Christchurch City

Surveyed by Davie, Lovell-Smith Limited

Scale 1:1000 Date July 2002

LOTS 67-106 & 610-615 BEING SUBDIVISION OF LOT 411 D.P. 81028

LAND DISTRICT Canterbury

SURVEY BLK. & DIST. VII Christchurch

NZMS 261 SH. Record Map No.

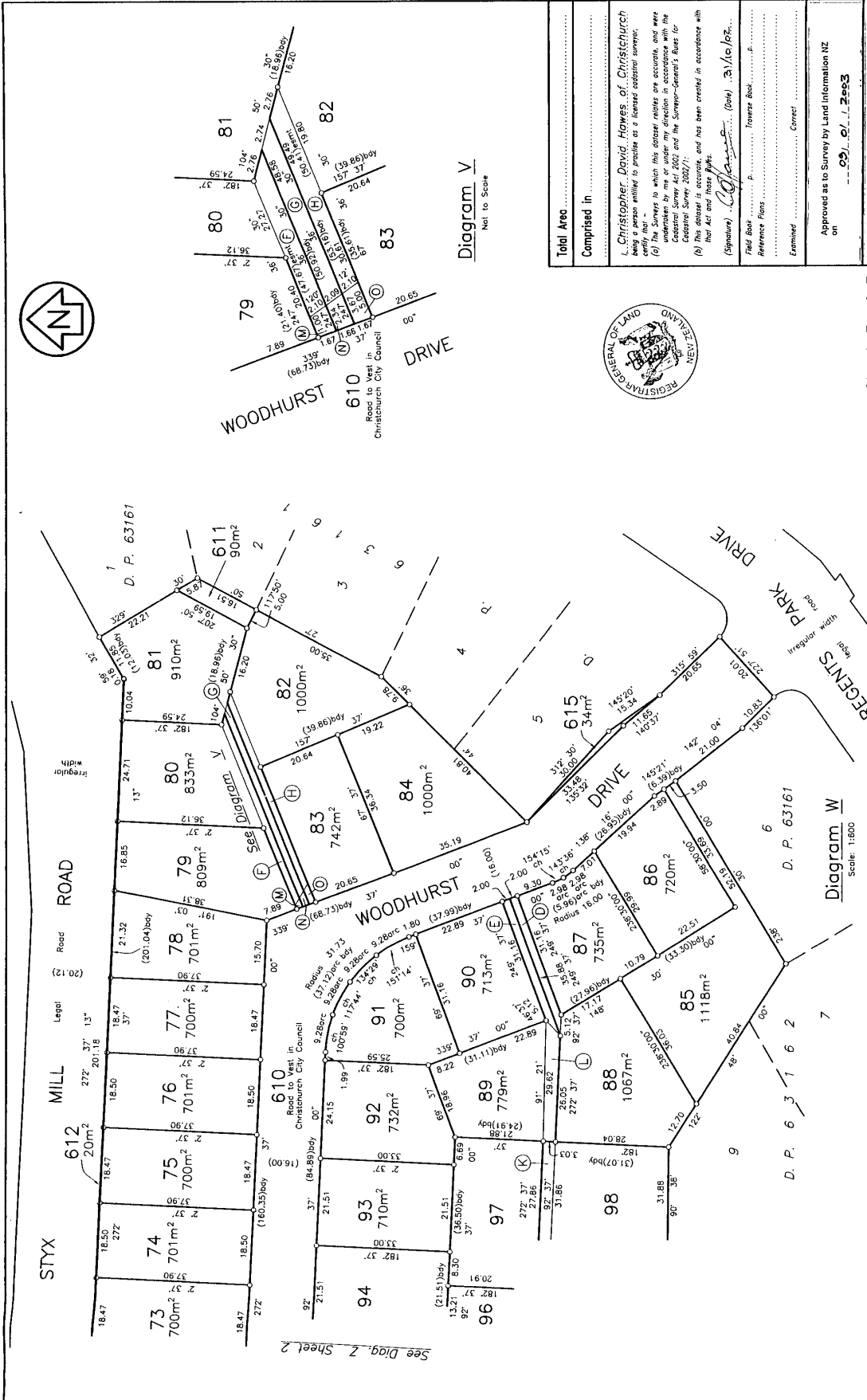

<b>Total Area</b> .....
<b>Comprised in</b> .....
L. Christopher David Hawes of Christchurch being a person entitled to practice as a licensed cadastral surveyor.
(a) The Survey in which this diagram relates are accurate, and were carried out in accordance with the Survey Act 2002 and the Surveyor-General's Rules for Cadastral Survey 2002/1.
(b) This diagram is accurate, and has been created in accordance with the Act and these Rules.
(Signature) <i>[Signature]</i> (Date) 31/07/2002
Field Book .....
Reference Plans .....
Examined .....
Approved as to Survey by Land Information NZ on 09/07/2003
Deposited by Land Information NZ on 22/07/2003
File Received 29-11-02
DP316821

Sheet 3 of 3  
 TERRITORIAL AUTHORITY Christchurch City  
 Surveyed by David Lovell-Smith Limited  
 Scale As Shown Date July 2002

DIAGRAMS V & W  
 Scale: 1:600

AND DISTRICT Canterbury  
 SURVEY BLK. & DIST. VII Christchurch  
 ZMS 261 SH1 Record Map No.

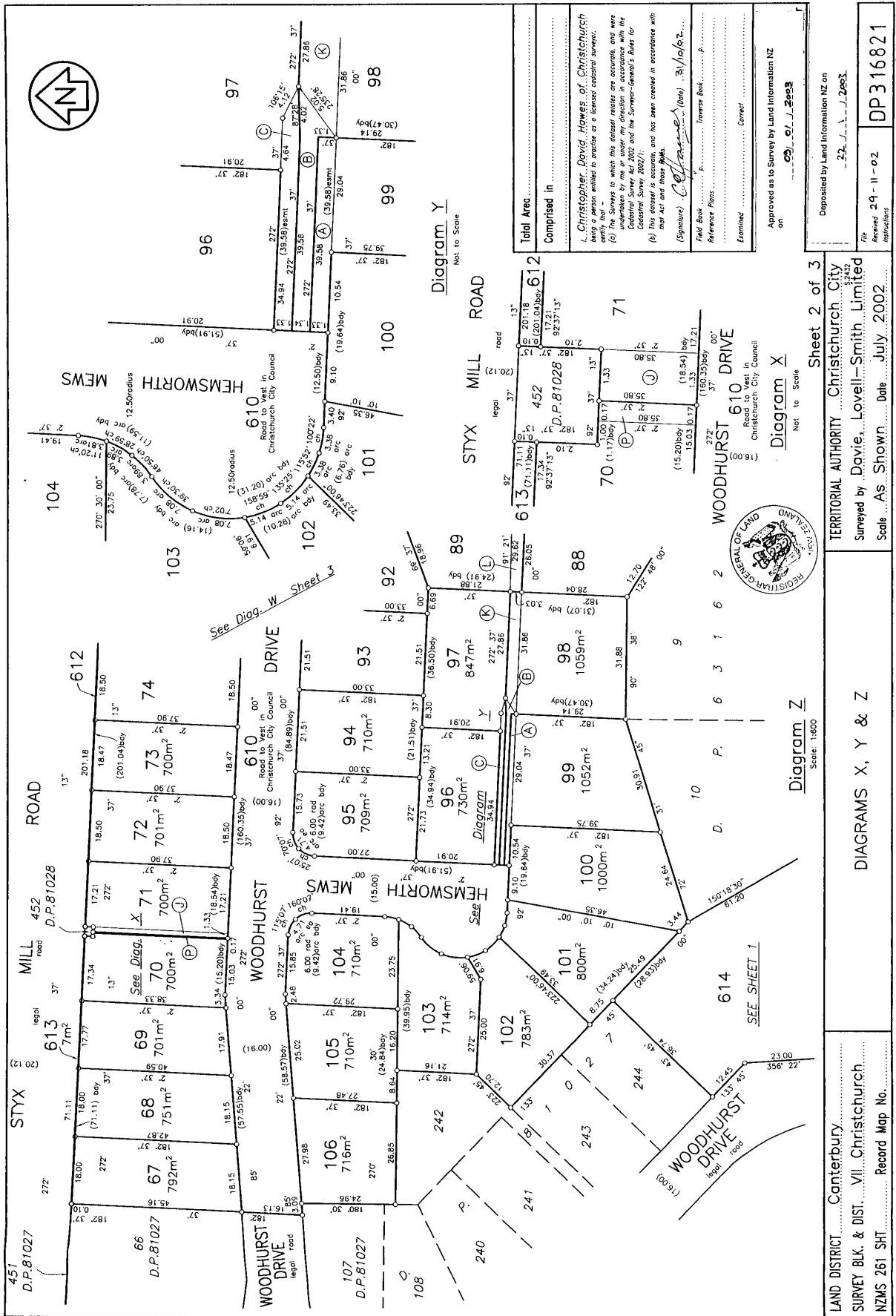

LAND DISTRICT Canterbury  
 SURVEY BLK. & DIST. VII Christchurch  
 NZMS 261\_SHT Record Map No.

Scale As Shown Date July 2002

TERRITORIAL AUTHORITY Christchurch City  
 Surveyed by Dave Lovell-Smith Limited

Sheet 2 of 3

Approved as to Survey by Land Information NZ  
 on 09.01.2003

Deposited by Land Information NZ on  
 22.1.2003

File Received 29-11-02 DP316821  
 Inspectors

LAST FORM 015 APPROVED 01/87

Total Area  
 Comprised in

L. Christopher David, Howes, of Christchurch  
 being a person entitled to exercise as a licensed cadastral surveyor,  
 (1) the Surveys to which this diagram relates are accurate, and were  
 undertaken by me or under my direction in accordance with the  
 Cadastral Survey Act 2002, and the Survey-General's Rules for  
 Cadastral Survey 2002/1;  
 (2) This diagram is accurate, and has been created in accordance with  
 that Act and those Rules.

(Signature) *Christopher David* Date 31/10/02

Field Book p. Traverse Book p.  
 Reference Plans p.  
 Examined Correct

